

Trustees of Washington Academy

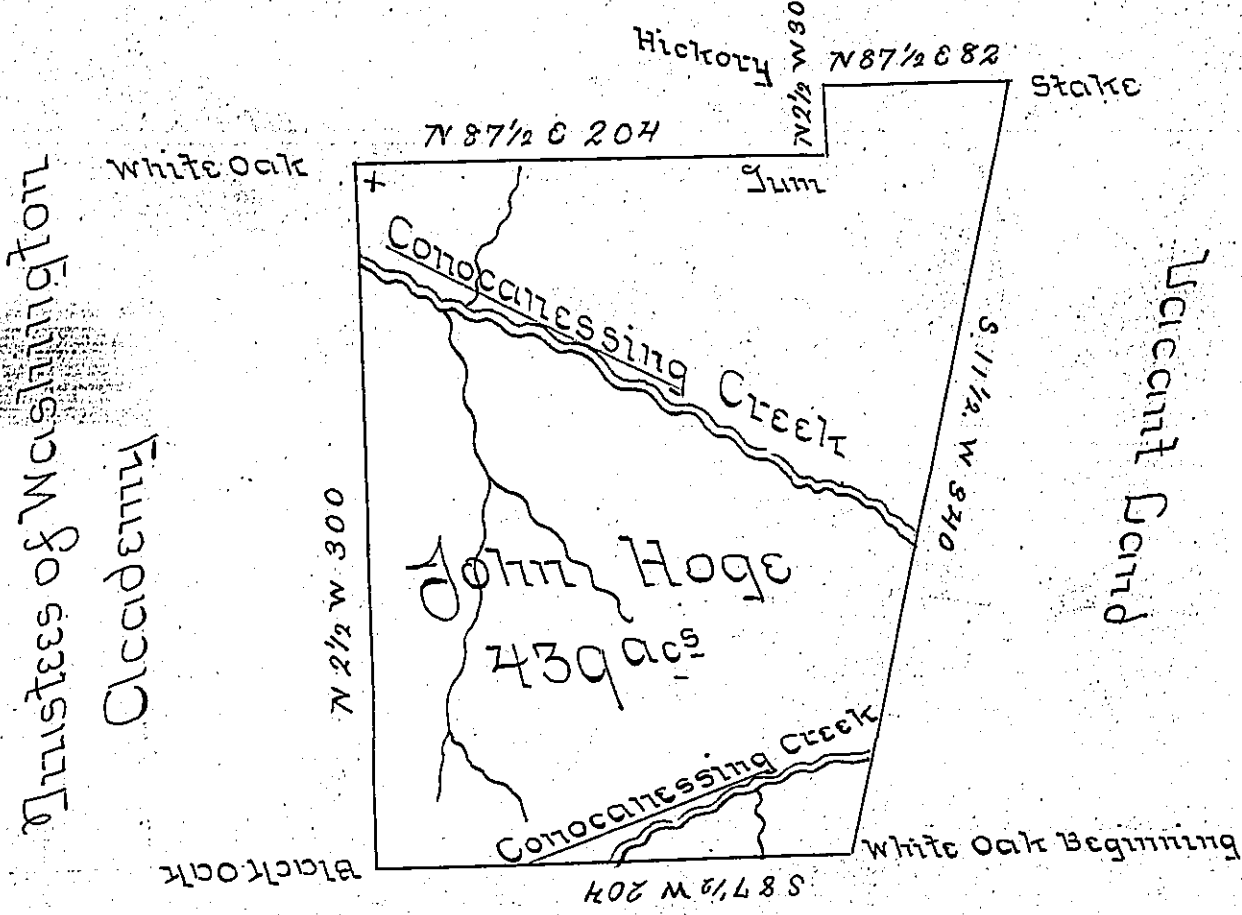

Trustees of Washington Academy

Decent Land

Decent Land

A Draught of a Tract of Land Surveyed November the 16th day 1793 in pursuance of a Warrant Granted to John Hoge for 400 Acres of Land Dated the 4th day of December in the Year 1792 Situate North and West of the River Ohio Allegany and Conawango Creek about two Miles below Brush Creek on the Conocanessing and about one Mile above Slippery Rock to include the Great Falls above the Mouth of Slippery Rock on the Conocanessing Creek and the Big Bend Called Great Falls Containing four hundred and thirty nine Acres together with the usual Allowance of Six P^{er} C^{ent} for Roads

Jonathan Beets U.S.

To Daniel Brodhead Esquire
Surveyor General

IN TESTIMONY that the above is a copy of the original remaining on file in the Department of Internal Affairs of Pennsylvania, made conformably to an Act of Assembly approved the 16th day of February, 1833, I have hereunto set my Hand and caused the Seal of said Department to be affixed at Harrisburg, this nineteenth day of April 1905.

Asa R. Perry
Secretary of Internal Affairs.